

3D Wall cladding panel

2,5 X 22 X 290CM



In & Out



Sanded texture, stylish slatted wall panels.

Beautiful, modern cladding for the inside & outside.

15 YEARS WARRANTY

IN GREY & COFFE COLOR

Boards

Dimension of the board 2,5 x 22 x 290cm



Environmental Features

- Does not contain toxic and dangerous substances, formaldehyde, or benzene.
- It does not pollute the air and the environment.
- 100% recyclable.

Formula of WPC

- HARDWOOD FIBER 60%
- FIRST RECYCLE OF HDPE PLASTIC..... 28,5%
- ADDITIVES COUPLING AGENT..... 3,5%
- MASTERBATCH..... 2%
- LUBRICANT AGENT..... 1,5%
- UVABSORBERS..... 2%
- PROCESS AIDS..... 2,5%

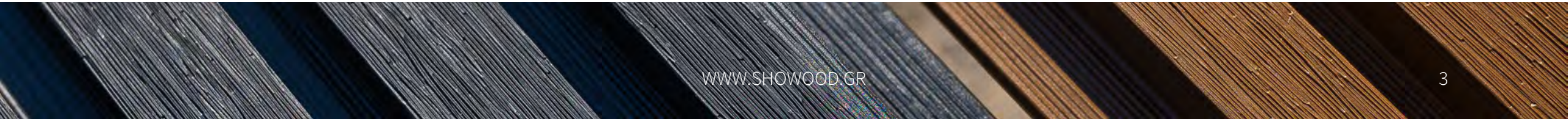



SHOWOOD

VALUABLE BY NATURE

Wall Solution

Look & Feel

Look and feel of natural wood. Does not require maintenance and painting. It has great color stability.

Warranty

15 years

Co-extrusion technique

The co-extrusion technique protects the composite material with a polyethylene film. The unique and exclusive formula of the polymer layer for surface protection guaranteed that there will be no discoloration.

Easy to assemble

Very easy installation. Installation with screws (hidden support) on a plastic, metal, or wooden frame.

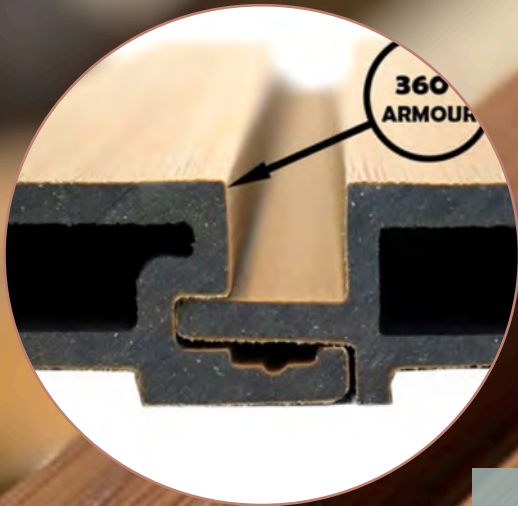

Co-extrusion technique

The unique and exclusive formula of the polymer layer for surface protection guaranteed that there will be no discoloration.

Assembling accessories



Single start profile

2,5 x 4,9 x 290cm



Joist Trim

2,5 x 6 x 290cm



L trim corner for gladding

4,6 x 8,9 x 290cm

Cladding System Installation



1

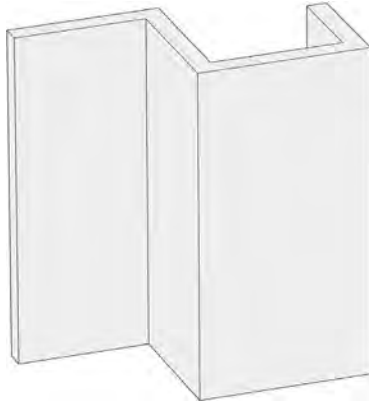

2

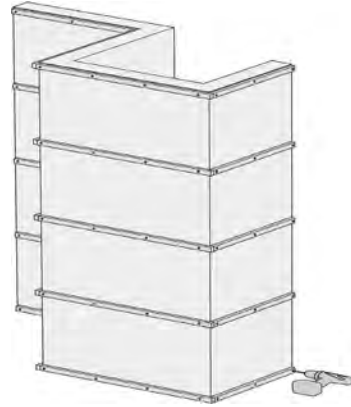

3

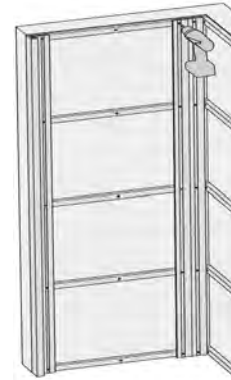

4

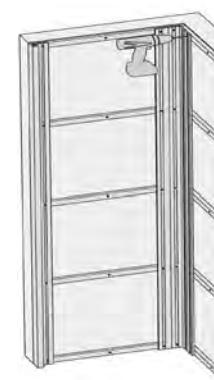

5

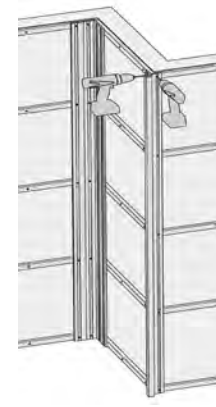

6



7

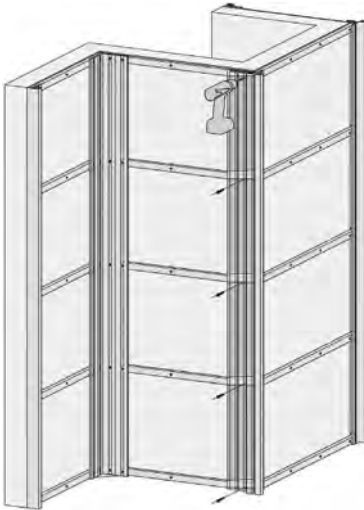

8

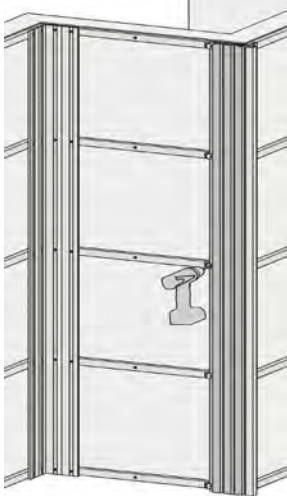

9

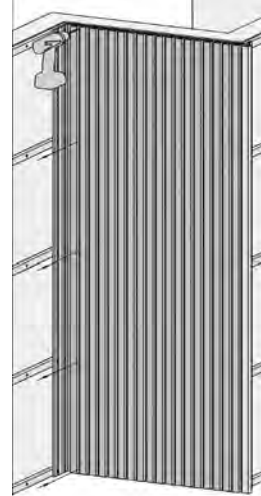

10

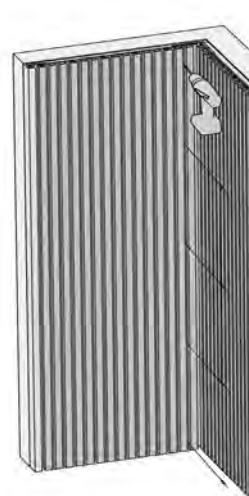

11

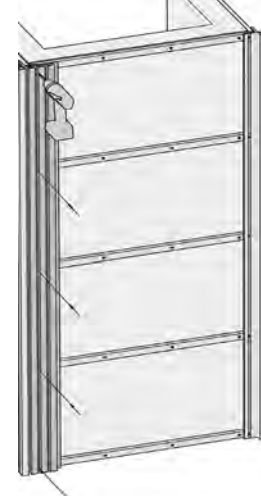

12

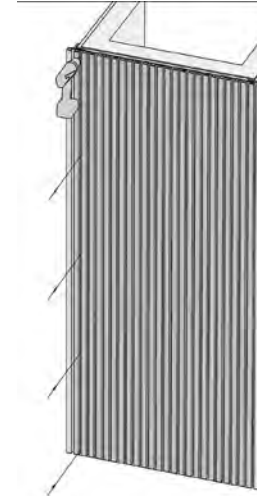

13

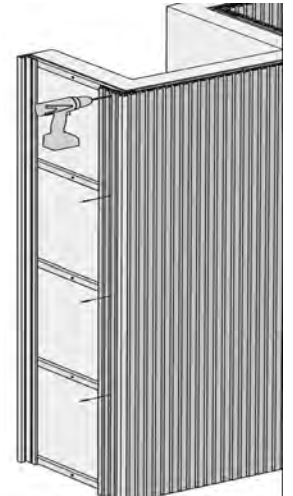

14

Cladding System Installation

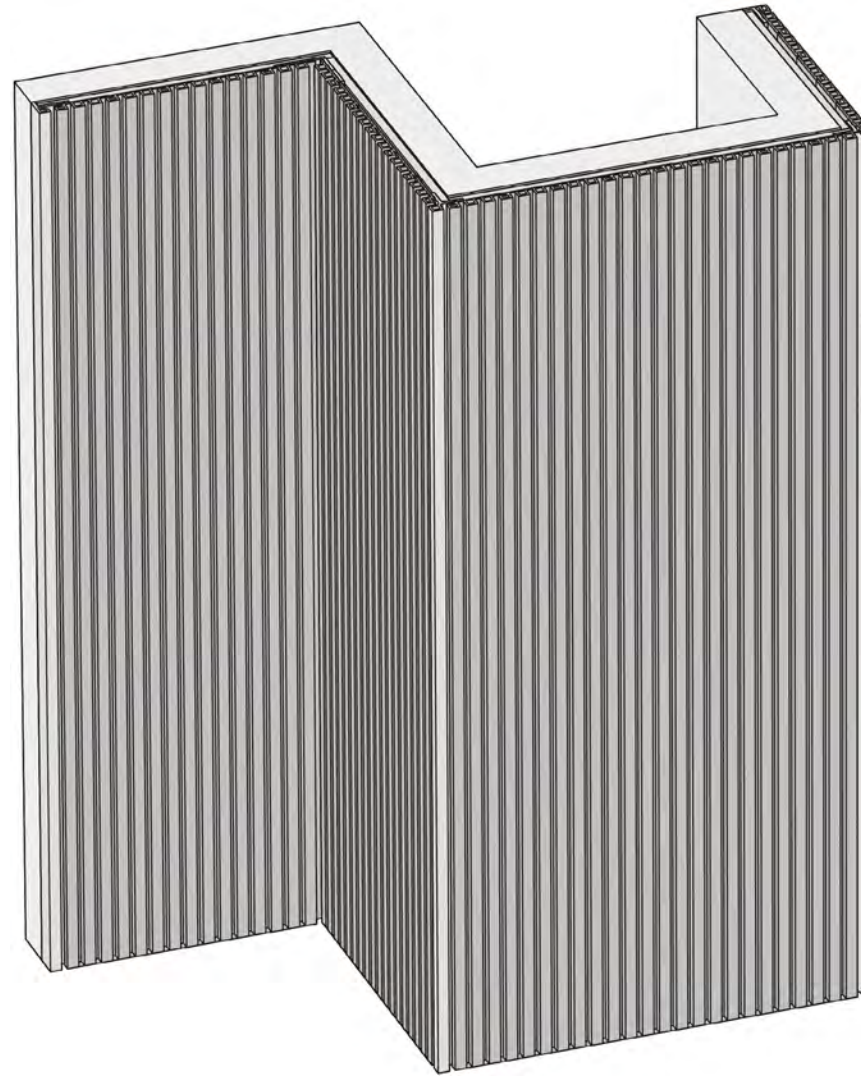
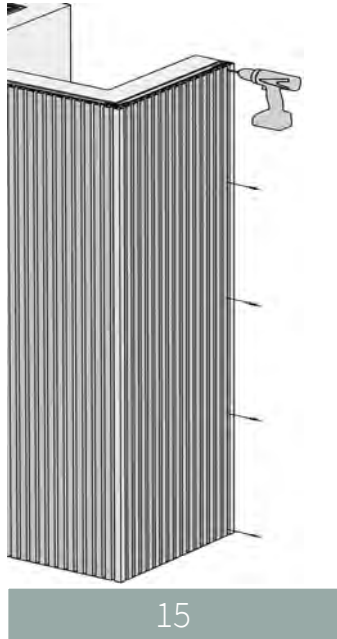

Tools

Standard woodworking tools may be used. It is recommended that all blades have a carbide tip. Standard stainless steel or acceptable coated deck screws and nails are recommended.

Screws

When choosing which screws/nails to use always check first with your local home centers and hardware stores to see if they have screws that are engineered specifically for composite wood. These screws/ nails will always work and give SHOWOOD'S products the best looking outcome.

Using other screws/ nails that are not recommended for composite could potentially damage/harm the cladding. If you are unsure which screw/nail to use, contact your manufacturer for more information.



Summary

- The strength is directly related to the base material used in the product.
- Our base material is 60% hardwood powder (softwood flour will be cheaper and worse).
- 30% primary recycled HDPE (If it is replaced by secondary recycling, tertiary recycling, or even LDPE, the price will be much lower and the hardness will be much weaker).
- 10% additives (The blending agent added to each of our products is 3.5%, and some factories only add about 2%. In addition, antioxidants, stabilizers, etc.)

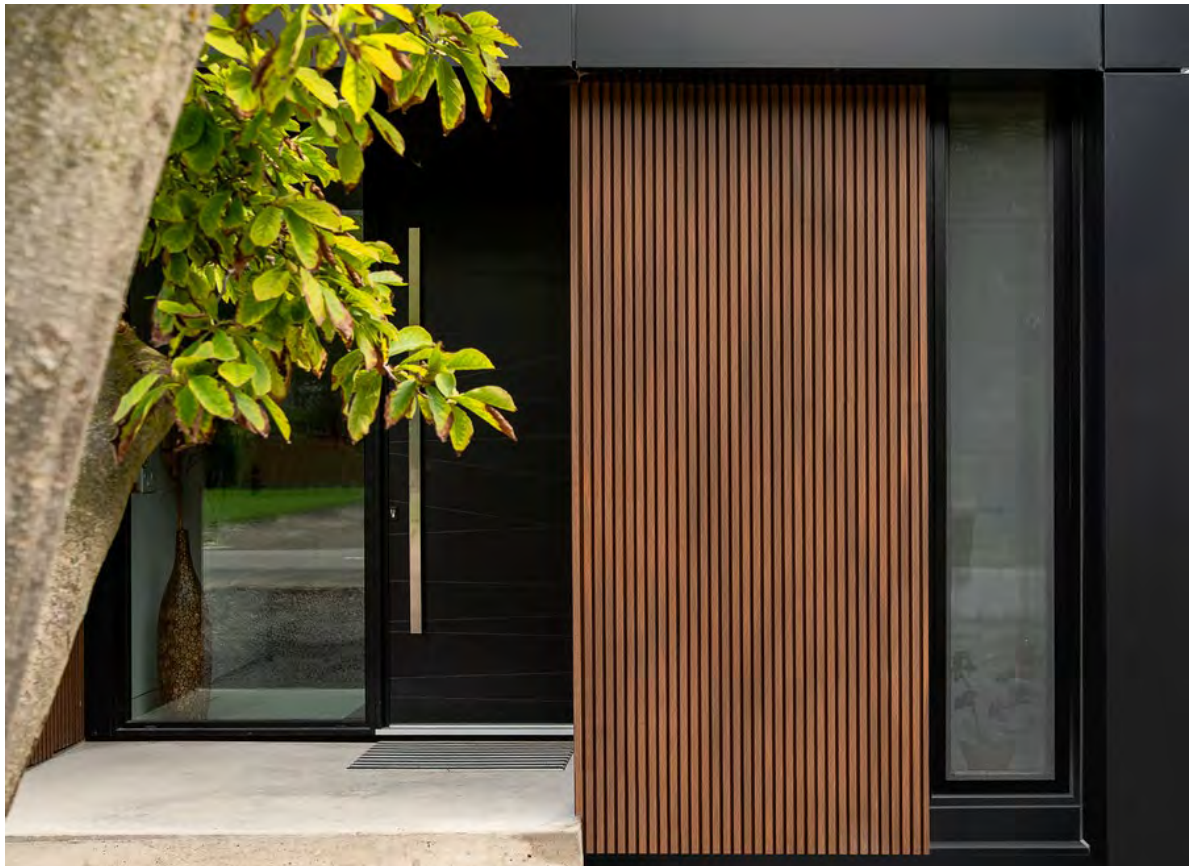

SHOWOOD
VALUABLE BY NATURE

Contact Us:

GREECE

+30 210 2478811

b2b@showood.gr

WWW.SHOWOOD.GR